

# Sandvik Multiprocessor BC Range



# Broad Operating and Application Range

The BC multiprocessor is designed to perform a broad array of duties. Engineered for both primary and secondary applications, these models are suitable for crushing concrete, cutting reinforced structures, pulverizing and demolition.

## **D-JAWS: CONCRETE DEMOLITION TOOL WITH TEETH OPTIONS FOR CONCRETE BREAKING, PULVERIZATION, WOOD CUTTING**

- Basic jaw for primary and secondary processing of concrete
- Maximum power and excellent power-to-weight ratio
- Replaceable wear parts
- Numerous teeth options





### **S-JAWS: CONCRETE AND STEEL BAR REINFORCEMENTS DEMOLITION**

- Specialist jaw for demolition of steel reinforced concrete structures
- Front teeth crush concrete; cutting blades slice through steel rebar
- Interchangeable blades ensure optimum productivity

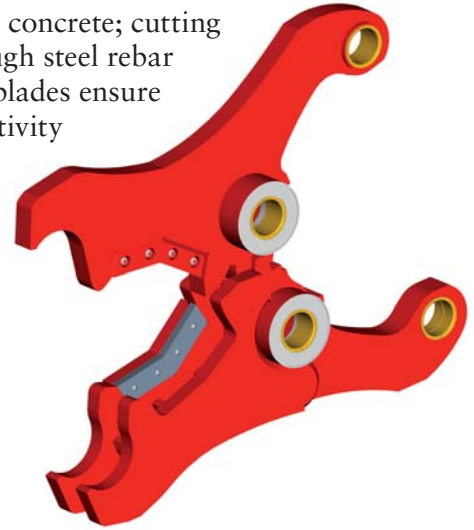

### **A-JAWS: EXTRA WIDE OPENING JAWS FOR PRIMARY DEMOLITION**

- Wider opening jaw adds versatility while non-bolted teeth design provides even more solid build
- Designed to meet demand for wider jaw opening
- Wide opening inner teeth can crack concrete



### **M-JAWS: CUTTING JAWS FOR STEEL DEMOLITION**

- Designed for steel demolition and occasional scrap splitting applications
- Beak shape jaw tip punches plates making it possible to tear down steel structures and welded beams



## BODY

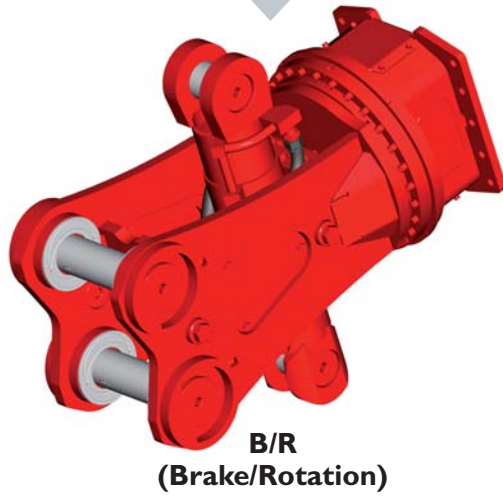

## JAWS



### TEETH OPTIONS FOR D-JAWS



### JAW EXCHANGE STAND

In order to exchange jaws on the BC-range cutter-crusher, we recommend the use of a purpose-built jaw exchange stand together with an excavator. The frame (shown in gray) is a simple design and can be readily manufactured locally.



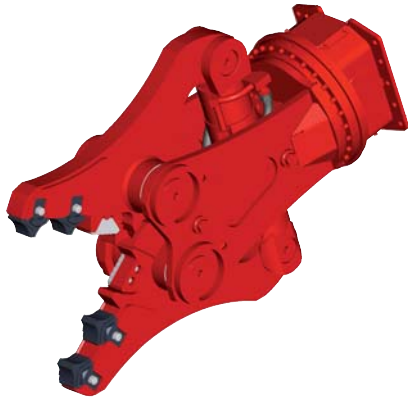

	<b>BC 807</b> (RD 7)	<b>BC 1515</b> (RD 15)	<b>BC 2019</b> (RD 19)	<b>BC 2525</b> (RD 25)	<b>BC 3032</b> (RD 32)
Weight, kg <sup>1)</sup>	592	1600	2350	2790	3300
Carrier Weight, t <sup>2)</sup>	6-10	10-18	16-25	22-35	28-35
Operating Pressure, bar	320	320	320	350	320
Operating Flow, l/min	150	230	230	230	280
Jaw Cycle Speed (Open and Close), s	2.5	2.5	4.2	4.7	4.6
Jaw Closing Speed, s	1.5	1.4	2.1	2.3	2.5
Rotation 360 (Degrees)	Standard Mechanical Hydraulic (Optional)	Standard Mechanical Hydraulic (Optional)	Standard Mechanical Hydraulic (Optional)	Standard Mechanical Hydraulic (Optional)	Standard Mechanical Hydraulic (Optional)
Max Pressure for Hydraulic Rotation, bar	120	120	120	120	120
Oil Flow for Hydraulic Rotation, l/min	30	30	30	30	30
<b>D-Jaw: Concrete Demolition Tool with teeth options for concrete breaking, pulverization, wood cutting</b>					
Maximum Jaw Opening, mm	–	556	702	829	912
Crushing Force (rear teeth), kN	–	900	1350	1420	1500
Crushing Force (front teeth), kN	–	640	880	1050	980
Concrete Rebar Cutting Blade Length, mm	–	130	130	180	220
Overall Length, mm	–	1832	1995	2151	2326
Jaw Width, mm	–	80	100	100	100
Width, pulverizer plates, mm	–	280	320	360	360
<b>S-Jaw: Concrete and Steel Bar Reinforcements Demolition</b>					
Maximum Jaw Opening, mm	–	543	853	892	928
Cutting blades/Rear teeth Opening mm	–	208	385	411	442
Crushing Force (front teeth), kN	–	509	692	846	828
Concrete Rebar Cutting Blade Length, mm	–	320	400	450	500
Overall Length, mm	–	1985	2211	2231	2440
Jaw Width, mm	–	180	220	220	220
<b>A-Jaw: Extra Wide Opening Jaws for Primary Demolition</b>					
Maximum Jaw Opening, mm	494	750	1000	1100	1186
Crushing Force (rear teeth), kN	440	799	1020	1135	1084
Crushing Force (front teeth), kN	290	500	640	701	700
Concrete Rebar Cutting Blade Length, mm	130	130	130	180	220
Overall Length, mm	1493	1992	2240	2386	2583
Jaw Width, mm	50	80	100	100	100
<b>M-Jaw: Cutting Jaws for Steel demolition</b>					
Maximum Jaw Opening, mm	–	–	373	–	–
Crushing Force, front, kN	–	–	700-850	–	–
Crushing Force, middle, kN	–	–	1200-1700	–	–
Cutting Blade Length, mm	–	–	425	–	–
Overall Length, mm	–	–	2089	–	–
Jaw Width, mm	–	–	220	–	–

<sup>1)</sup> Without mounting bracket

<sup>2)</sup> Standard boom carrier. Check carrier's lifting capacity and stability



## **SPARE PARTS**

As a leading supplier to the demolition and recycling sectors for many years, Sandvik Rammer recognizes the need for high quality, readily accessible spare parts. Utilizing efficient central warehousing linked to a global dealer network that is unparalleled in the demolition industry, Sandvik Rammer ensures that you get the right parts, in the right place, at the right time.



## **GLOBAL DEALER NETWORK**

Sandvik Rammer's global dealer network ensures that you are never more than a phone call away from a dependable and responsive source of expertise, advice and spare parts. Manned by knowledgeable personnel trained to Sandvik Rammer's exacting standards, the global dealer network is your local source of hammer and attachment expertise and experience.

